

# Library Hours

www.library.ucsb.edu/hours

# Fall 2024

805-893-2478 Information

## Public Hours

All floors,  
all visitors

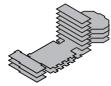

### Fall Quarter

Thu, Sep 26–Sat, Nov 30  
Sunday  
Monday–Thursday  
Friday  
Saturday

**Regular Hours**  
10 AM–10 PM  
8 AM–10 PM  
8 AM–9 PM  
10 AM–9 PM

### Veterans' Day

Sunday, Nov 10  
Monday, Nov 11

**Holiday Hours**  
10 AM–10 PM  
10 AM–5 PM

### Thanksgiving

Wednesday, Nov 27  
Thursday, Nov 28  
Friday, Nov 29  
Saturday, Nov 30

**Holiday Hours**  
8 AM–5 PM  
Closed  
Closed  
10 AM–5 PM

### Dead Week & Finals Week

Sunday, Dec 1  
Mon, Dec 2–Thu, Dec 12  
Friday, Dec 13

**Extended Hours**  
10 AM–6 PM  
8 AM–6 PM  
8 AM–6 PM

### Winter Break

Saturday, Dec 14  
Sunday, Dec 15  
Mon, Dec 16–Thu, Dec 19  
Friday, Dec 20

**Recess Hours**  
10 AM–5 PM  
Closed  
8 AM–5 PM  
8 AM–5 PM

## LATE NIGHT STUDY Campus ID required

All floors

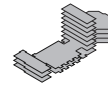

Floors 1-2

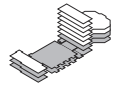

**Regular Hours**  
10 PM–1 AM  
10 PM–1 AM

...  
...

**Holiday Hours**  
10 PM–1 AM

...

**Holiday Hours**

...  
...  
...  
...

**Extended Hours**

6 PM–1 AM  
6 PM–1 AM

...

**Recess Hours**

...  
...  
...  
...

**Regular Hours**  
1 AM–8 AM  
1 AM–8 AM  
9 PM–10 AM  
9 PM–10 AM

**Holiday Hours**  
1 AM–10 AM  
5 PM–9 PM

**Holiday Hours**  
Closed  
Closed  
Closed  
5 PM–9 PM

**Extended Hours**

1 AM–8 AM  
1 AM–8 AM  
6 PM–Midnight

**Recess Hours**

5 PM–9 PM  
Closed  
5 PM–9 PM  
Closed

## Library Closed Friday, December 20 at 5 PM – Wednesday, January 1, 2025

Thu, Jan 2–Sun, Jan 5  
Thursday–Friday  
Saturday  
Sunday

**Recess Hours**  
8 AM–5 PM  
10 AM–5 PM  
Closed

**Recess Hours**

...  
...  
...

**Recess Hours**

5 PM–9 PM  
5 PM–9 PM  
Closed



For Service Desk hours (DREAM Lab, Services, Special Research Collections, and Music Library) see: [www.library.ucsb.edu/hours](http://www.library.ucsb.edu/hours)

Visitors are welcome to use the UCSB Library during public hours.



## LATE NIGHT STUDY

is for UCSB students, faculty, and staff with a campus ID.